

Student

# *Hastings Street*

Loughborough

2 Bed Terraced House • LE11 5AX • £110 pppw • £300 Deposit Per Person



## Hastings Street, Loughborough

Fully furnished two bedroomed property suitable for students or sharers ideally situated for the town centre and the University Campus. The property comprises of two reception rooms, fitted kitchen with a range of white goods, two fully furnished double bedrooms and a shower room. The property also has a cellar which provides ample storage space. There is a small yard to the rear of the property and on street parking. Available 1st July 2025. 2025 - 2026 Academic Year.

### Lounge 3.5m (11'6) x 3.4m (11'2)

Good sized lounge at the front of the property complete with furniture.

### Kitchen Diner 4.2m (13'9) x 3.5m (11'6)

Complete with Gas oven and hob, Fridge freezer, Washing machine and dining table and chairs.

### Bedroom One 3.5m (11'6) x 3.4m (11'2)

Fully furnished large double bedroom overlooking the front of the property.

### Bedroom Two 3.4m (11'2) x 2.5m (8'2)

Fully furnished double bedroom overlooking the rear of the property.

### Shower room 2.2m (7'3) x 1.6m (5'3)

Shower room complete with electric shower, wash hand basin and toilet.

### Garden

Enclosed rear yard

### Utilities

Sorry, bills not included

### Parking

On street parking with residents parking permit.

### Heating

Gas fired central heating.

### Glazing

Upvc double glazing.

### Energy Performance

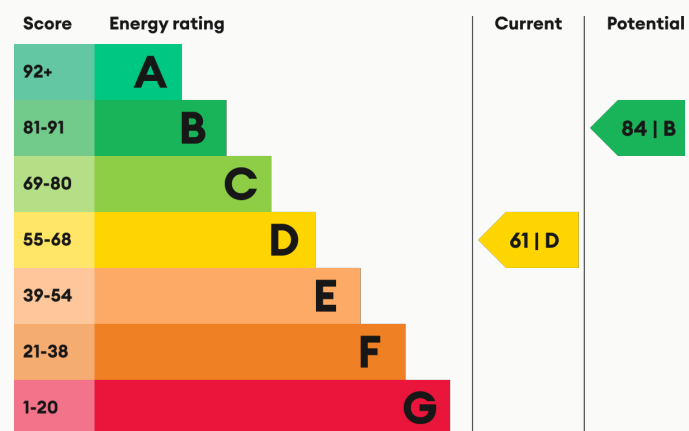

We aim to make our particulars both accurate and reliable. However they are not guaranteed; nor do they form part of an offer or contract. If you require clarification on any points then please contact us, especially if you are traveling some distance to view. All measurements are to widest point.



Lounge



Bedroom



Bedroom



Shower Room

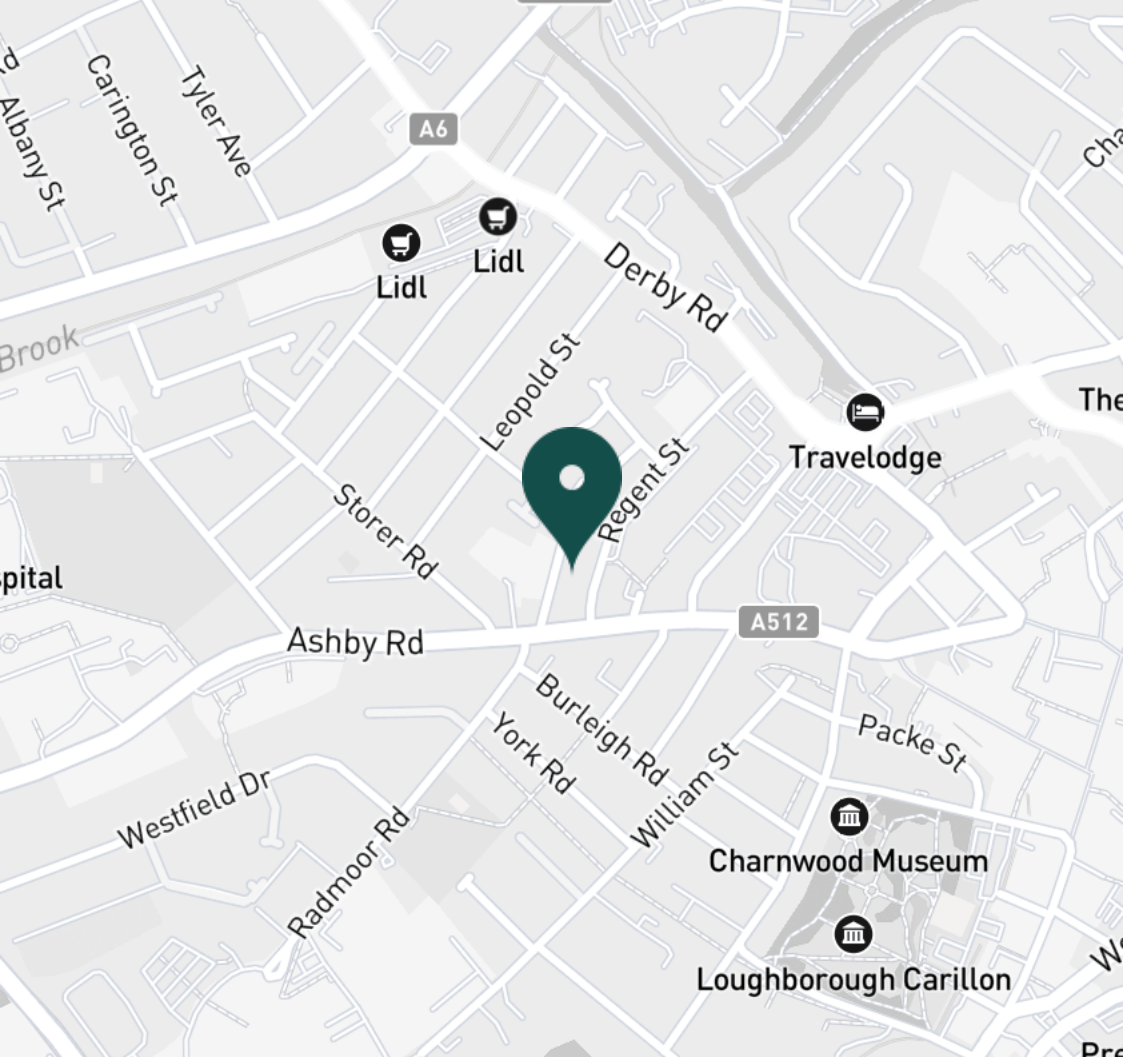

### SUPERMARKETS

Lidl Loughborough	0.3 mi
Sainsburys Loughborough	0.4 mi
Tesco Superstore Loughborough	0.4 mi
Aldi Loughborough	0.8 mi
Marks & Spencer	1.2 mi

### GYMS

Anytime Fitness Loughborough	0.3 mi
PureGym Loughborough	0.5 mi
CrossFit Loughborough	0.8 mi
Loughborough University Pool	0.8 mi
Fit4Less	0.9 mi

### TRAIN STATIONS

Loughborough	1.2 mi
Barrow upon Soar	4.3 mi
Sileby	6.2 mi
East Midlands Parkway	9.9 mi
Syston	10.2 mi

### NURSERY SCHOOLS

Busy Bees in Loughborough	0.2 mi
Kingscliffe Day Nursery	0.3 mi
Small World Nursery	0.4 mi
Babblebrooke Day Nursery	0.4 mi
Little House Day Nursery	0.9 mi

### PRIMARY SCHOOLS

St Marys Catholic PS	0.2 mi
Loughborough CE PS	0.5 mi
Rendell Primary School	0.8 mi
Cobden PS	1.0 mi
Our Lady's Convent Sch	1.1 mi

### HIGH SCHOOLS

RNIB College Loughborough	0.4 mi
Limehurst Academy	0.5 mi
Loughborough College	0.9 mi
Lboro Uni School Of The Arts	1.0 mi
Our Lady's Convent Sch	1.1 mi

Discover  
*Loughborough*



- ✓ Prime location off Ashby Rd
- ✓ Fully furnished
- ✓ For 2025/26 academic year
- ✓ Low maintenance garden
- ✓ Two Bed House
- ✓ Students





Kitchen and Breakfast area



Kitchen and Breakfast area



Utility area



Hastings Street

**Available**  
From 01/07/2025

**Comes**  
Furnished

**Bedrooms**  
2

**Receptions**  
2

**Bathrooms**  
1

**Parking**  
On Street

**Postcode**  
LE11 5AX

**Rent**  
£110 pppw

**Deposit**  
£600

**EPC**  
61 | D

**Council Tax Band**  
A

**ID**  
#267

**Updated**  
30/10/2024

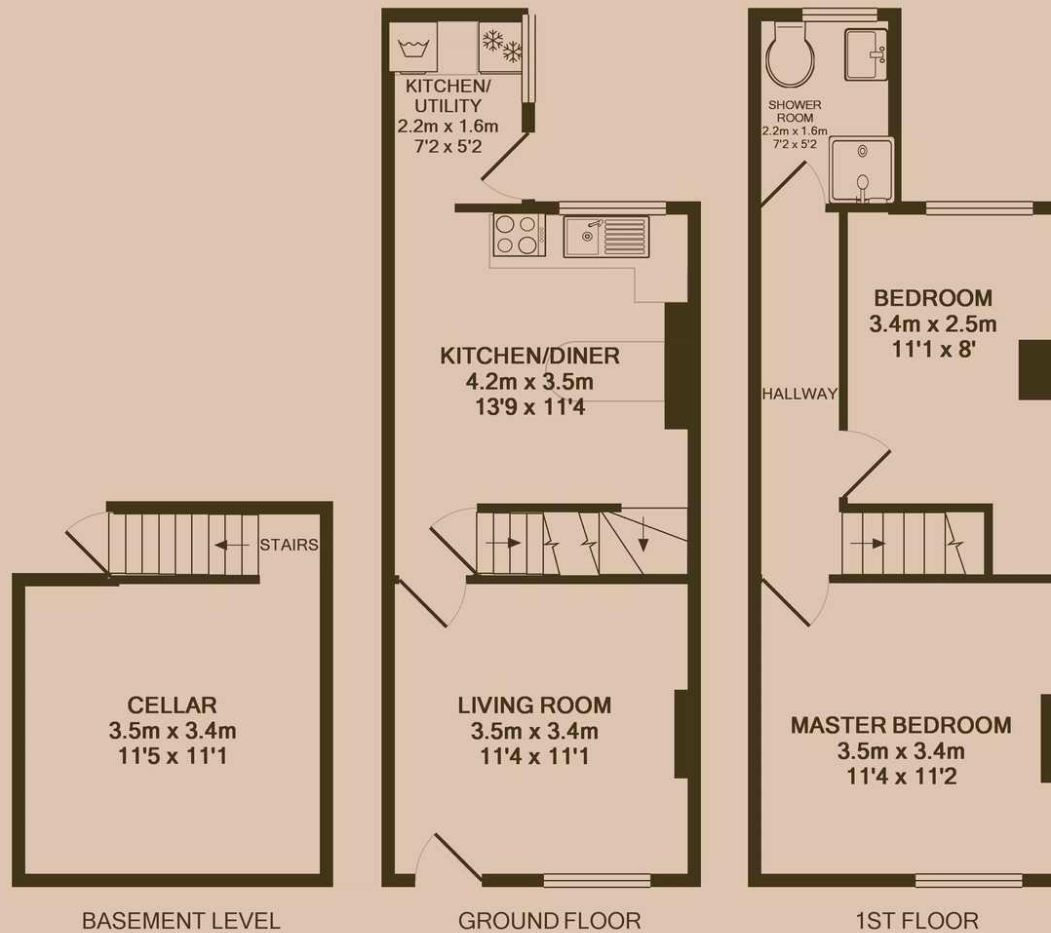

# *Have a property like this? Let's work together.*

Design and marketing are at the heart of our approach. With most people now looking for property online, we can get our clients' properties in front of as many people as the most prominent national agents. Where we differ is in the quality of our work. We create stunning digital particulars that highlight the individual attributes of every property we market, with videos and floor plans as standard.



**OUR OFFICE**  
7 Biggin Street  
Loughborough, LE11 1UA

**CONTACT US**  
01509 320 320  
let@huntleys.net



# Huntleys

