



King Edward Road
Loughborough

1 Bed 1st Floor Apartment • LE11 1RY • £775 pcm • £890 Deposit



King Edward Road, Loughborough

A stunning contemporary apartment located in this quiet area close to Loughborough town centre. Situated on the first floor and presented in excellent condition. It's well planned layout combined with its decor make for a bright and warm space. The apartment is within a short walk of the restaurants and cinema of the new Baxtergate development as well as the mainline station (both 10 minutes by foot), with buses providing access to the surrounding areas.

Living Room 4.19m (13'9") x 3.2m (10'6")

A spacious and light space, neutrally decorated, with smart blinds over the large window.

Kitchen 4.17m (13'8") x 2.64m (8'8")

Good quality modern kitchen in cream with dark wood style worktop. Includes integrated fridge-freezer, slim-line dishwasher, washing machine, oven and gas hob. Smart tiling and blinds completes the look.

Master Bedroom 4.01m (13'2") x 3.2m (10'6")

A surprisingly generous proportioned and light room. Like the rest of the house it is presented in excellent condition.

Bathroom 1.9m (6'3") x 1.68m (5'6")

Modern three piece bathroom suite complete with shower over the bath. High grade tiling completes the look.

Office / Store 1.99m (6'6") x 1.4m (4'7")

This smaller room would make a great office, store or guest room.

Parking

Car park situated to rear with further on street parking available on both King Edward Road and Elms Grove without restriction.

Heating

Gas fired central heating.

Glazing

Modern, good quality, uPVC double glazing.

Energy Performance

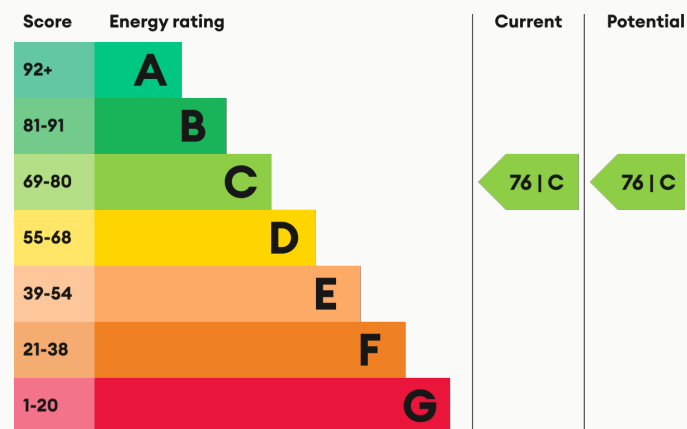

We aim to make our particulars both accurate and reliable. However they are not guaranteed; nor do they form part of an offer or contract. If you require clarification on any points then please contact us, especially if you are traveling some distance to view. All measurements are to widest point.



Bathroom



Bedroom



Bedroom



Bedroom



SUPERMARKETS

Marks & Spencer	0.8 mi
Tesco Superstore Loughborough	1.1 mi
Tesco Extra Loughborough	1.2 mi
Lidl Loughborough	1.3 mi
Sainsburys Loughborough	1.4 mi

GYMS

NPC Performance Centre	0.4 mi
Dynamite Gym Ltd	0.5 mi
Fit4Less	0.7 mi
PureGym Loughborough	0.8 mi
Anytime Fitness Loughborough	1.0 mi

TRAIN STATIONS

Loughborough	1.1 mi
Barrow upon Soar	3.3 mi
Sileby	5.2 mi
Syston	9.2 mi
South Wigston	10.4 mi

NURSERY SCHOOLS

Lime Tree Nursery	0.1 mi
Shelthorpe Childrens Centre	0.8 mi
Westwards Nursery	0.8 mi
Cobden Childrens Centre	0.9 mi
Emmanuel PS	0.9 mi

PRIMARY SCHOOLS

Fairfield Preparatory Sch	0.3 mi
Cobden PS	0.6 mi
Loughborough Grammar Sch	0.7 mi
Loughborough High Sch	0.7 mi
Beacon Primary Academy	0.8 mi

HIGH SCHOOLS

Loughborough Grammar Sch	0.7 mi
Loughborough High Sch	0.7 mi
Limehurst Academy	1.0 mi
Our Lady's Convent Sch	1.0 mi
Loughborough College	1.6 mi

Discover
Loughborough

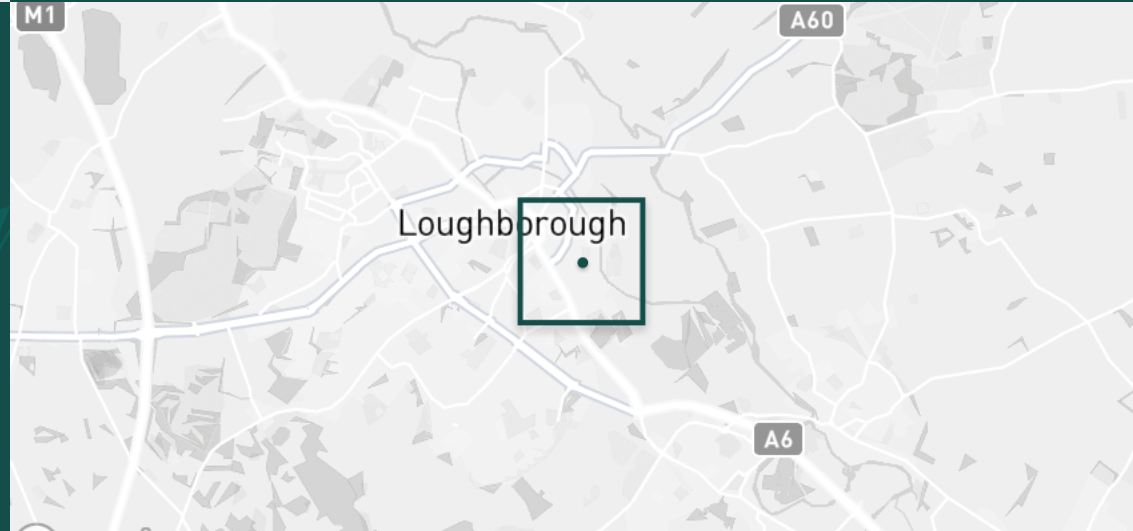

- ✓ High specification
- ✓ Contemporary apartment
- ✓ First floor
- ✓ Appliances included
- ✓ Walk to town
- ✓ Plenty of parking
- ✓ Excellent condition
- ✓ Attic storage





Living room



Living room



Office / Store



Office / Store



King Edward Road



King Edward Road



Kitchen

Available
From 18/03/2025

Comes
Unfurnished

Bedrooms
1

Receptions
2

Bathrooms
1

Parking
Allocated

Postcode
LE11 1RY

Rent
£775 pcm

Deposit
£890

EPC
76 | C

Council Tax Band
A

ID
#1201

Updated
20/02/2025

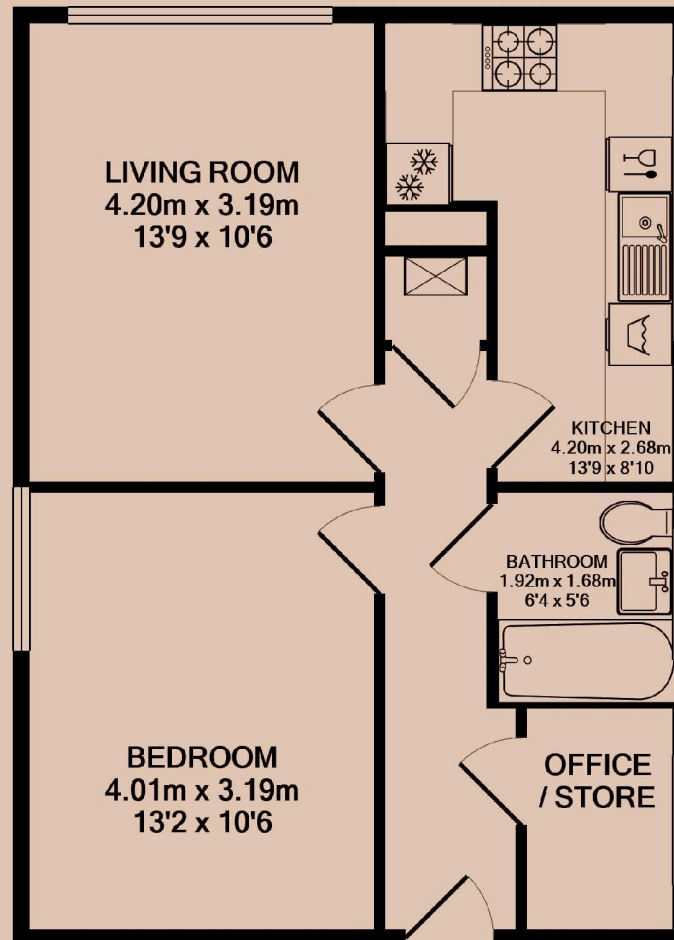

Have a property like this? Let's work together.

Design and marketing are at the heart of our approach. With most people now looking for property online, we can get our clients' properties in front of as many people as the most prominent national agents. Where we differ is in the quality of our work. We create stunning digital particulars that highlight the individual attributes of every property we market, with videos and floor plans as standard.



OUR OFFICE
7 Biggin Street
Loughborough, LE11 1UA

CONTACT US
01509 320 320
let@huntleys.net



Huntleys

