

A photograph of a living room interior. On the left, there is a fireplace with a stone surround and a dark wood mantelpiece. The fireplace opening is black. To the right of the fireplace is a window with a white frame. Further right is a doorway leading to a kitchen, where a sink and wooden cabinets are visible. The floor is made of light-colored wood. The walls are white. A light fixture is visible on the ceiling.

Burder Street

Loughborough

2 Bed Terraced House • LE11 1JL • £850 pcm • £980 Deposit



Burder Street, Loughborough

Conveniently situated close to the town centre. This smart Victorian two bedroom terraced house has neutral decoration throughout. Its a great choice for those wanting to be near all the towns amenities. The well-presented accommodation comprises of a living room; dining room; kitchen with utility space; two double bedrooms; bathroom; low maintenance rear garden; gas central heating and on street permit parking.

Lounge

A spacious and bright living room, set at the front of the property.

Dining Area

Open to the kitchen and staircase, a second reception room. Could be used as a second lounge or dining area.

Kitchen

A quaint kitchen, open to the dining area. A practical kitchen including a fridge/freezer and oven and hob.

Utility Room

A small utility room situated beside the kitchen, includes a washing machine.

Master Bedroom

The larger of the two bedrooms, overlooking Burder Street. A spacious and bright double bedroom.

Bedroom Two

A second double bedroom, overlooking the rear garden.

Bathroom

A sizeable bathroom, overlooking the rear garden. Includes a bath, sink, toilet and shower over the bath.

Garden

A quaint and low maintenance garden, includes a outhouse for storage.

Parking

On street parking available on Burder Street with a permit.

Heating

Gas-fired central heating.

Glazing

Modern, good quality, uPVC double glazing.

Energy Performance

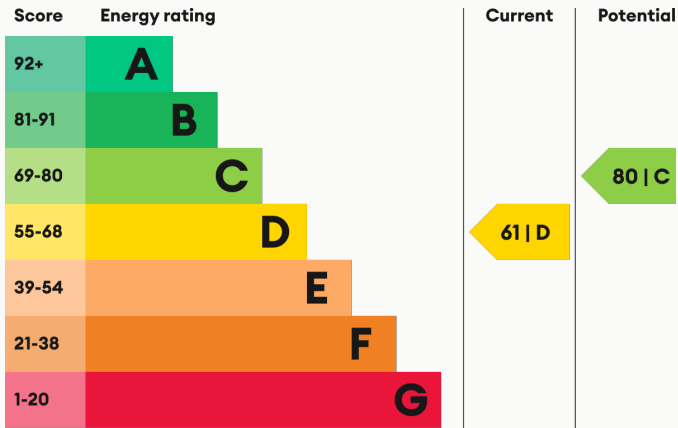

We aim to make our particulars both accurate and reliable. However they are not guaranteed; nor do they form part of an offer or contract. If you require clarification on any points then please contact us, especially if you are traveling some distance to view. All measurements are to widest point.



Dining Area



Dining Area



Lounge



Lounge

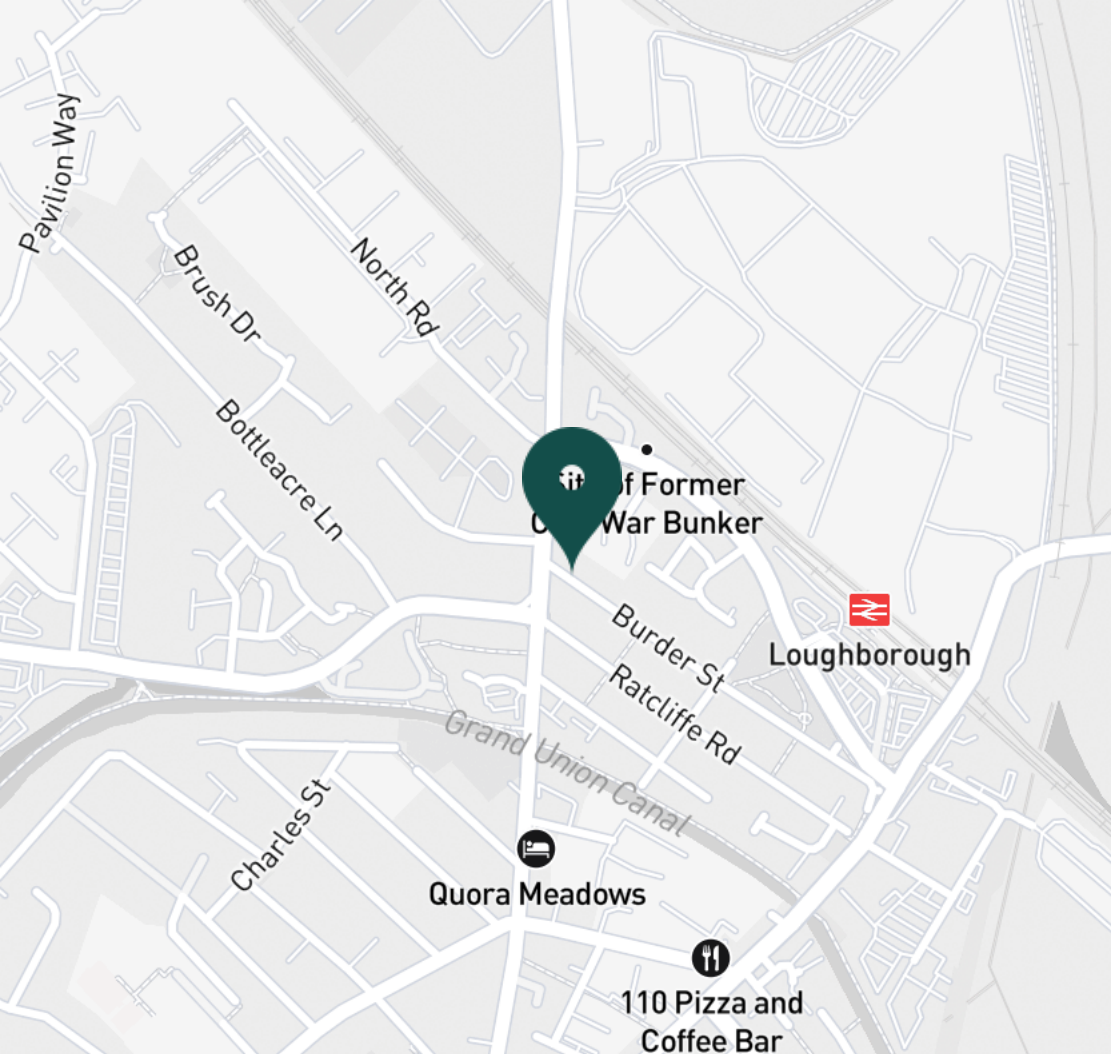

SUPERMARKETS

Aldi Loughborough	0.5 mi
Tesco Superstore Loughborough	0.7 mi
Marks & Spencer	0.8 mi
Lidl Loughborough	0.9 mi
Sainsburys Loughborough	1.1 mi

GYMS

CrossFit Loughborough	0.2 mi
PureGym Loughborough	0.6 mi
Anytime Fitness Loughborough	0.7 mi
Dynamite Gym Ltd	0.9 mi
NPC Performance Centre	1.2 mi

TRAIN STATIONS

Loughborough	0.4 mi
Barrow upon Soar	5.6 mi
Sileby	6.2 mi
East Midlands Parkway	10.2 mi
Syston	10.5 mi

NURSERY SCHOOLS

Babblebrooke Day Nursery	0.6 mi
Cobden Childrens Centre	0.7 mi
Small World Nursery	1.0 mi
Lime Tree Nursery	1.0 mi
Busy Bees in Loughborough	1.2 mi

PRIMARY SCHOOLS

Rendell Primary School	0.4 mi
Cobden PS	0.9 mi
St Marys Catholic PS	1.0 mi
Fairfield Preparatory Sch	1.2 mi
Loughborough CE PS	1.4 mi

HIGH SCHOOLS

Limehurst Academy	0.5 mi
RNIB College Loughborough	1.4 mi
Our Lady's Convent Sch	1.4 mi
Loughborough High Sch	1.6 mi
The Garendon High Sch	1.8 mi

Discover
Loughborough

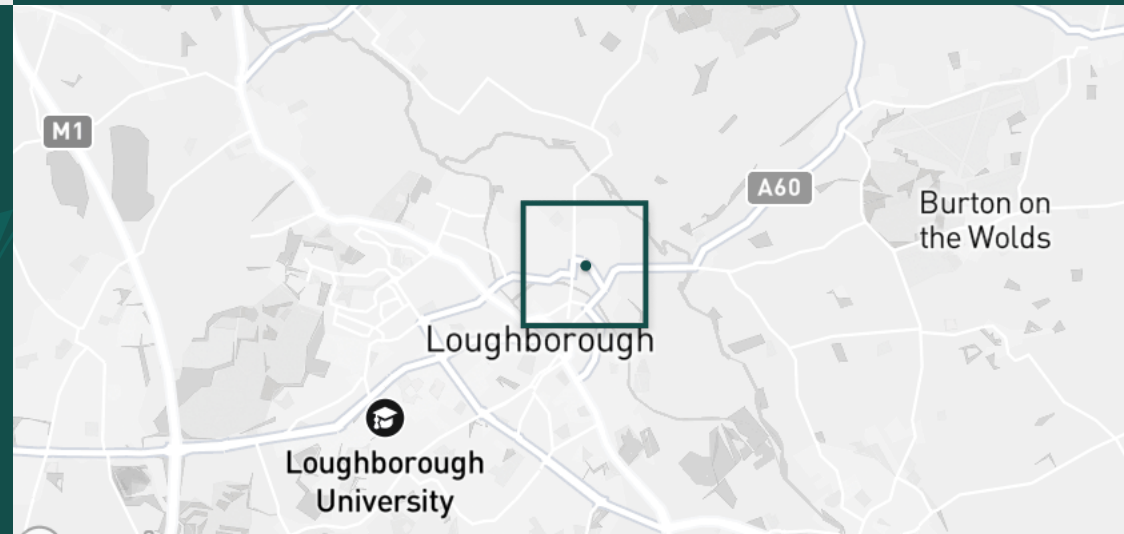



Lounge



Lounge



Kitchen



Kitchen



Kitchen

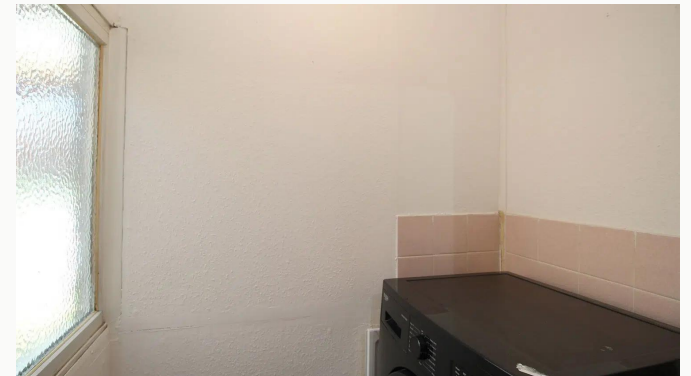

Utility Room



Sun Room



Sun Room



Master Bedroom



Master Bedroom



Master Bedroom



Bedroom Two



Bedroom Two



Bedroom Two



Bathroom



Burder Street



Garden



Garden

Available
From 03/07/2025

Comes
Unfurnished

Bedrooms
2

Receptions
2

Bathrooms
1

Parking
With permit

Postcode
LE11 1JL

Rent
£850 pcm

Deposit
£980

EPC
61 | D

Council Tax Band
A

ID
#10526

Updated
17/06/2025

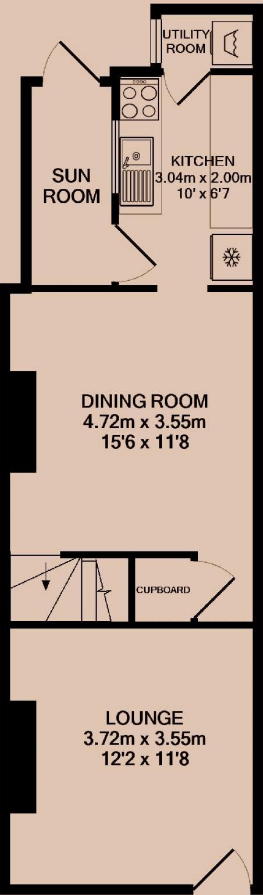

GROUND FLOOR

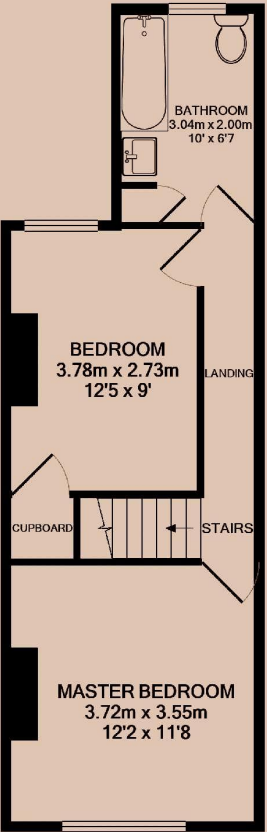

1ST FLOOR

Have a property like this? Let's work together.

Design and marketing are at the heart of our approach. With most people now looking for property online, we can get our clients' properties in front of as many people as the most prominent national agents. Where we differ is in the quality of our work. We create stunning digital particulars that highlight the individual attributes of every property we market, with videos and floor plans as standard.



OUR OFFICE
7 Biggin Street
Loughborough, LE11 1UA

CONTACT US
01509 320 320
let@huntleys.net

