



Knighthorpe Road
Loughborough

4 Bed Detached House • LE11 5JR • £1,250 pcm • £1,440 Deposit



Knighthorpe Road, Loughborough

Now available to let in Loughborough. A semi-detached, four-bedroom house in great condition. On the ground floor is a lounge, open to the kitchen diner, sun room, double bedroom and water closet. On the first floor is three more bedrooms and a shower room. To the front of the property is driveway parking and to the rear is a garden. Please note: The garage is not included and the garden will be cleared.

Lounge

A bright and spacious lounge, open to the kitchen diner.

Kitchen / Diner

A kitchen that runs around/is open to the lounge. This kitchen comes with a Fridge/freezer, Fridge under the counter, Washing machine, Oven and Hob.

Sun Room

Located at the rear of the property, a conservatory that overlooks the rear garden.

Master Bedroom

A double bedroom set on the first floor, overlooking Knighthorpe Road.

Bedroom Two

A second double bedroom on the first floor, over looking the rear garden.

Bedroom Three

A third bedroom on the first floor.

Bedroom Four

A fourth bedroom, a double bedroom, set on the ground floor.

Shower Room

Set on the first floor, a three piece shower room. Includes a walk-in-shower, sink and toilet.

Water Closet

A water closet, situated under the stairway. This room comes with a toilet and sink.

Garden

Set to the rear of the property. A sizeable garden. Please note: This garden will be attended by a gardener.

Parking

Driveway parking available along with additional parking available on Knighthorpe Road. Please note: The garage is not included.

Heating

Gas-fired central heating.

Glazing

Modern, good quality, uPVC double glazing.

Energy Performance

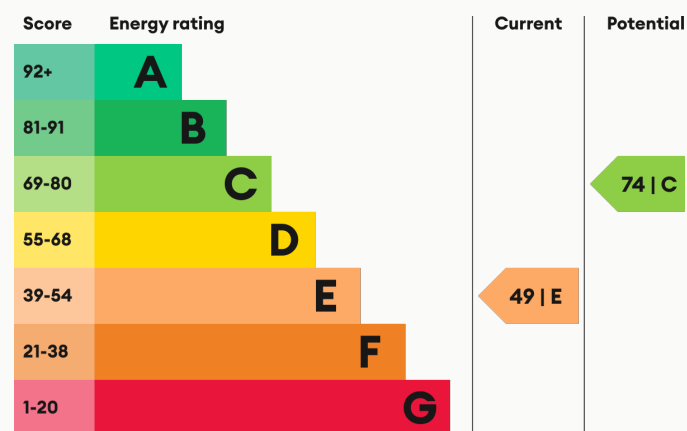

We aim to make our particulars both accurate and reliable. However they are not guaranteed; nor do they form part of an offer or contract. If you require clarification on any points then please contact us, especially if you are traveling some distance to view. All measurements are to widest point.



Lounge



Lounge



Kitchen / Diner



Kitchen / Diner



SUPERMARKETS

Co-op Food Knightthorpe Rd	0.2 mi
Morrisons Loughborough	0.6 mi
Lidl Loughborough	0.9 mi
Aldi Loughborough	1.1 mi
Tesco Superstore Loughborough	1.2 mi

GYMS

Loughborough University Pool	0.8 mi
Loughborough Sport	0.8 mi
Radmoor Centre	0.9 mi
Anytime Fitness Loughborough	1.1 mi
PureGym Loughborough	1.3 mi

TRAIN STATIONS

Loughborough	1.9 mi
Barrow upon Soar	4.7 mi
Sileby	6.6 mi
East Midlands Parkway	9.3 mi
Long Eaton	11.5 mi

NURSERY SCHOOLS

Little House Day Nursery	0.5 mi
Robert Bakewell Playgroup	0.6 mi
Charnwood College Playgroup	0.8 mi
Kingscliffe Day Nursery	0.8 mi
Loughborough Campus Nursery	0.9 mi

PRIMARY SCHOOLS

Robert Bakewell PS	0.6 mi
Thorpe Acre Junior Sch	0.7 mi
Ashmount Sch	0.8 mi
Booth Wood PS	0.9 mi
St Marys Catholic PS	1.0 mi

HIGH SCHOOLS

The Garendon High Sch	0.6 mi
De Lisle Catholic Science C	0.8 mi
Charnwood College	0.8 mi
Ashmount Sch	0.8 mi
Loughborough College	0.9 mi

Discover
Loughborough

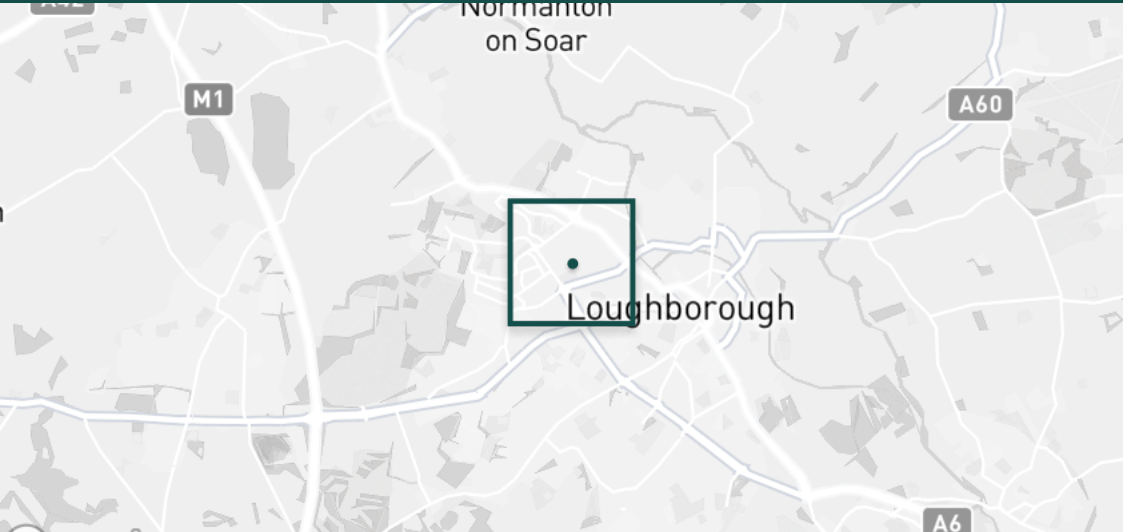

- ✓ Four Bedrooms
- ✓ Close to University
- ✓ Garage
- ✓ Great Condition
- ✓ Garden
- ✓ Appliances Included





Kitchen / Diner



Kitchen / Diner



Kitchen / Diner



Sun Room



Sun Room



Master Bedroom



Master Bedroom



Master Bedroom



Bedroom Two



Bedroom Two



Bedroom Two



Bedroom Three



Bedroom Three



Bedroom Four



Bedroom Four



Bedroom Four



Shower Room



Shower Room



Landing



Hallway



Hallway



Water Closet



Knightthorpe Road



Garden



Garden



Garden

Available
From 04/09/2024

Comes
Furnished

Bedrooms
4

Receptions
1

Bathrooms
1

Parking
Driveway

Postcode
LE11 5JR

Rent
£1,250 pcm

Deposit
£1,440

EPC
49 | E

Council Tax Band
D

ID
#9980

Updated
05/10/2024

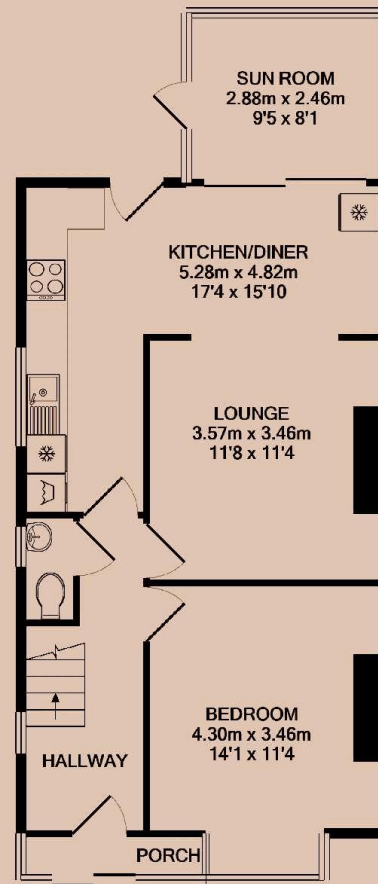

GROUND FLOOR

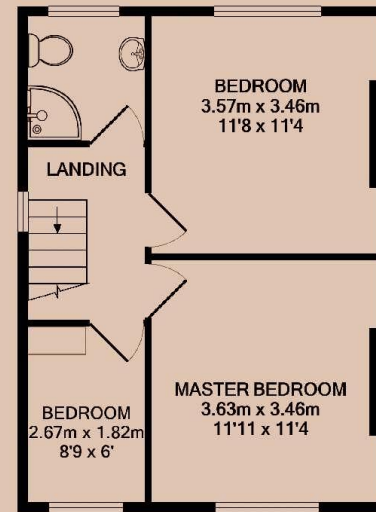

1ST FLOOR

Have a property like this? Let's work together.

Design and marketing are at the heart of our approach. With most people now looking for property online, we can get our clients' properties in front of as many people as the most prominent national agents. Where we differ is in the quality of our work. We create stunning digital particulars that highlight the individual attributes of every property we market, with videos and floor plans as standard.



OUR OFFICE
7 Biggin Street
Loughborough, LE11 1UA

CONTACT US
01509 320 320
let@huntleys.net

